

## GENERAL INFORMATION

Project Name: \_\_\_\_\_

## STANDARD SPECIFICATIONS

- 1" Diameter Post & Bracket in Brushed Stainless Steel Finish
- 3/8" Clear Tempered Front Glass Panels (max. span 66")
- 1/4" Clear Tempered Glass End Panels
- 1" Radius Glass Corners

## OPTIONS AND ACCESSORIES

### NSF-LISTED FINISH OPTIONS

- Brushed Stainless (Standard)
- Gloss Black

### GLASS THICKNESS

- 1/4" Clear Tempered Front Glass Panels (max. span 54" - not for shelves)
- 3/8" Clear Tempered Front Glass Panels (max. span 66") (Standard)
- 1/2" Clear Tempered Front Glass Panels (max. span 72" - for shelf or span more than 66")

### GLASS FINISHES

- Clear (Standard)
- Frosted
- Pattern
- Low Iron
- Frosted Logo/Imprint

### GLASS CORNERS

- 1" Radius Corners (Standard)
- Square Corners

## LIGHT & WARMER OPTIONS

All BSI light units are UL Listed. See light spec sheets for detailed information. Also available with other manufacturers' light units. Contact BSI for details.

- | Model #                       | Description            |
|-------------------------------|------------------------|
| <input type="checkbox"/> 2580 | Slimline LED Light     |
| <input type="checkbox"/> 705  | Stealth Light & Warmer |

## MOUNTING STYLES (SELECT ONE)

See installation page for more details.

**Above Counter:** Stainless Steel Counter

**Under Counter:** Stainless Steel Counter  
(Requires under-counter reinforcement and access.)

**Above Counter:** Millwork Counter

**Under Counter:** Millwork Counter  
(Compression installation not recommended for solid surface countertops.)

- |   |   |
|---|---|
| <input type="checkbox"/> EZ Mount - 2" x 8" Flange      | <input type="checkbox"/> Narrow, Inverted Flange    |
| <input type="checkbox"/> Heavy-Duty, Inverted Flange    | <input type="checkbox"/> Narrow, Upright Flange     |
| <input type="checkbox"/> Heavy-Duty, Upright Flange     |   |
| <input type="checkbox"/> Heavy-Duty Flange              | <input type="checkbox"/> Narrow Flange              |
| <input type="checkbox"/> Heavy-Duty, Inverted Flange    | <input type="checkbox"/> Narrow, Inverted Flange    |
| <input type="checkbox"/> Heavy-Duty, Compression Flange | <input type="checkbox"/> Narrow, Compression Flange |

## AG2930-3

### Two Tier, Open Shelf w/U-Shaped Post

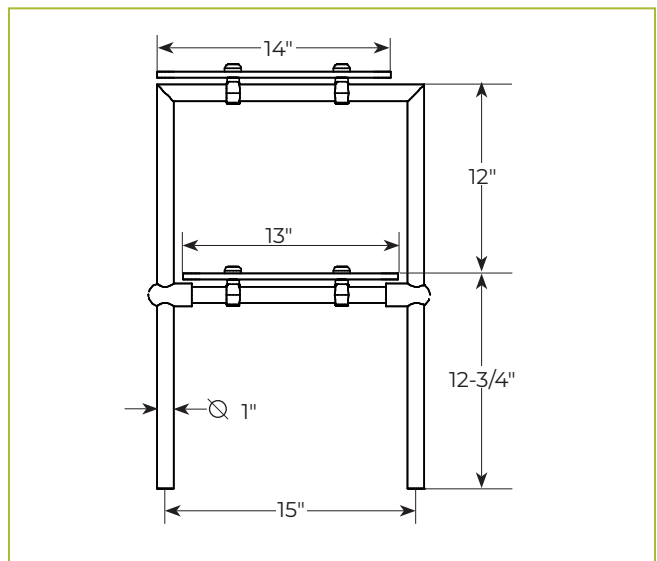

To meet NSF guidelines, end panels are included on all BSI quotations unless specifically excluded. (See end panel page for more details.)

To meet NSF guidelines the upper tier will be labeled "For prepackaged food only".

